

RoHS2.0&REACH Compliant

THE PART MEETS TECONN "GPO01" COMPLIANCE NEW REV.

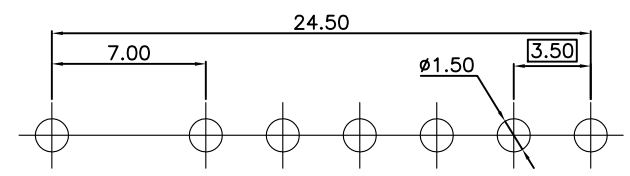
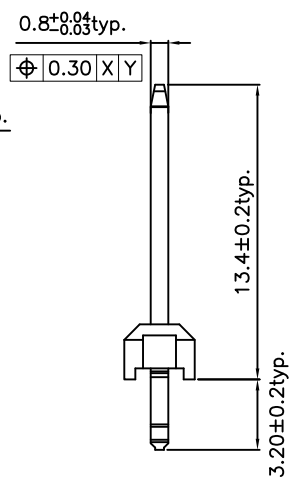
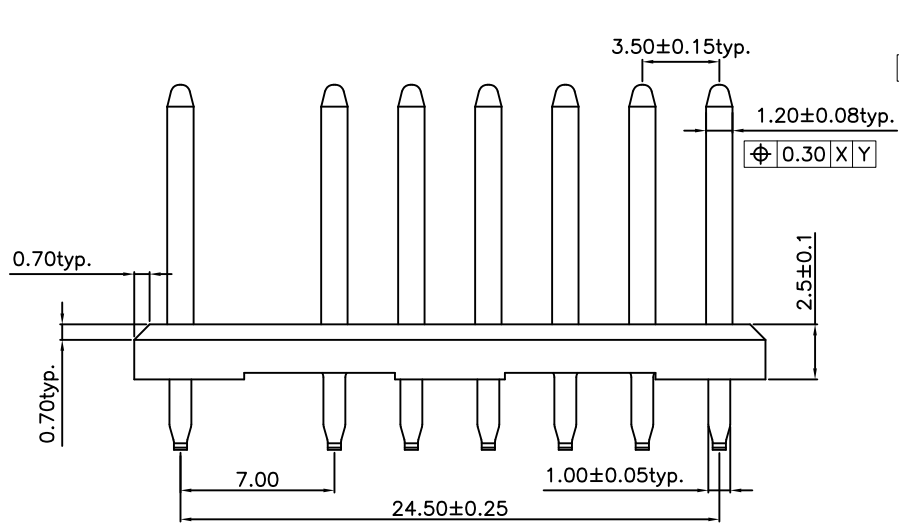
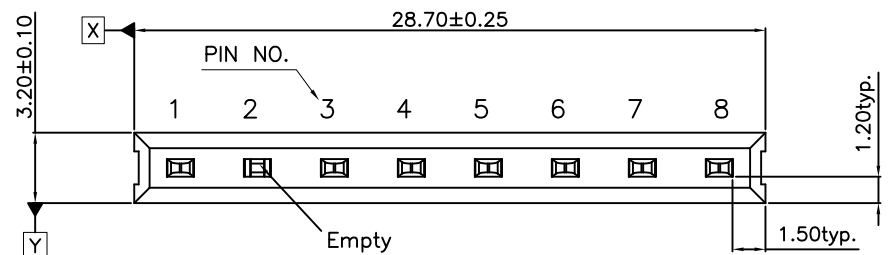

Recommended PCB Layout (Top View)
TOLERANCES: ± 0.05

- Note:
- Material:
 - Housing: LCP+40%GF, UL94 V-0, Black
 - Contact: Brass(C1100), 40u"~200u" Matt Tin plating all over, 30u"~150u" Nickel underplating;
 - Ratings
 - Current Rating (额定电流): 12.0 A (Per Pin);
 - Operating Temperature (工作温度): $-40^{\circ}\text{C} \sim +125^{\circ}\text{C}$;
 - Electrical Requirement:
 - LLCR (接触阻抗): 20m Ω Max. (Initial), 30m Ω Max. (Final);
 - Dielectric Withstanding Voltage (耐电压): 500V AC (RMS) for 1minuter;
 - Insulation Resistance (绝缘阻抗): 1000M Ω Min. @ 500V DC;
 - Single pin push out force 5.5N Min. after solder to PCB.
 - The part is recommended for ir reflow solodering process peak soldering temperature is 260°C Max 10 Secs Max.
 - The total mass is 1.18g per unit.

Part No:
A990710-A-OS-T

Pin No: 07: 7PIN
Packing: T: Tray
Plating: OS: Matt Tin

REV	ECN NO	DESCRIPTION	DESIGN	DATE
A	TE2019-0066	New Drawing	Mike Xu	2019/05/20

X. ± 0.35	APPD: Lebon Lee	TITLE: 3.5Pitch Pin Header 1x8P Single Row(7PIN)	
.X ± 0.25	CHKD: /	PART NO: A990710-A-OS-T	
.XX ± 0.15	DR: Mike Xu	DWG NO: C-A990710-A-OS-T	
.XXX \pm		CUSTOMER DRAWING	SHEET: 10F1
X' $\pm 2^{\circ}$			REV: A
X' $\pm 1.5^{\circ}$			